

UHF low insertion loss combiners with ferrite isolators for the 380-512 MHz Band



KC(S-D)U8-X-100 series is low insertion loss combiners with ferrite isolators and 8" cavities used for combining several transmitters into one antenna with up to 300 kHz (UHF) frequency spacing. Combiners are configured in sets of 2, 3,4.. up to 8 channels with 100 W input and SWR < 1.5. Mounting option is specified by customer vertically or horizontally into EIA 19" etc.

Combiners are tuned at customer specified frequencies, so transmit frequencies should be specified when ordering.



SPECIFICATIONS

ELECTRICAL

	KCSU8-2-100	KCDU8-2-100	KCSU8-3-100	KCDU8-3-100	KCSU8-4-100	KCDU8-4-100
Channels	2	2	3	3	4	4
Isolator	Single	Dual	Single	Dual	Single	Dual
Frequency Range	380-512 MHz	380-512 MHz	380-512 MHz	380-512 MHz	380-512 MHz	380-512 MHz
Max input power	100W CW	100 W CW	100 W CW	100 W CW	100 W CW	100 W CW
Spacing Tx-Tx	>250 KHz	>250 KHz	>250 KHz	>250 KHz	>250 KHz	>250 KHz
Isolation Tx-Tx, dB	> 60 dB	> 80 dB	> 60 dB	> 80 dB	> 60 dB	> 80 dB
Insertion losses@Tx-Tx spacing	2.3@150	2.3@150	2.8@450	2.8@450	3.3@450	3.3@450
Nominal impedance	50	50	50	50	50	50
Connector	N - female	N - female	N - female	N - female	N - female	N - female
Operating Temperature	-35°C +50°C	-35°C +50°C	-35°C +50°C	-35°C +50°C	-35°C +50°C	-35°C +50°C
Dimensions (H x W x D) mm	400x420x210	400x420x210	400x630x210	400x630x210	400x420x420	400x420x420
Weight	10 Kg	11 Kg	15 Kg	16 Kg	25 Kg	27 Kg

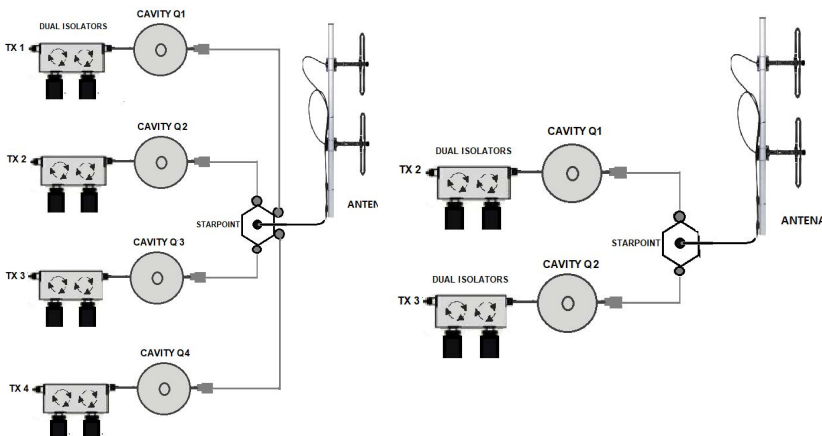

Mechanical Drawing Single isolator

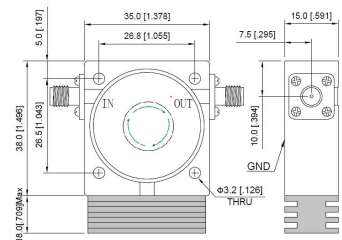

Mechanical Drawing Dual isolator

