

VHF Hybrid type combiners with ferrite isolators for the 380-512 MHz Band



RTH(S-D)U-X-50 series hybrid type combiners with single or dual ferrite isolators used for combining several transmitters into one antenna with up to 25 kHz (VHF) frequency spacing. Combiners are configured in sets of 2, 3 or 4 TX channels with 100W input and SWR < 1.5. Mounting option is specified by customer horizontally into EIA 19" etc.

Combiners are tuned at customer specified frequencies, so transmit frequencies should be specified when ordering.



SPECIFICATIONS

ELECTRICAL

	KHSU-2-100	KHDU-2-100	KHSU-3-100	KHDU-3-100	KHSU-4-100	KTHDU-4-100
Channels	2	2	3	3	4	4
Isolator	Single	Dual	Single	Dual	Single	Dual
Frequency Range	380-512MHz	380-512 MHz	380-512 MHz	380-512 MHz	380-512 MHz	380-512 MHz
Max input power	50 W	50 W	50 W	50 W	50 W	50 W
Spacing Tx-Tx	>25 KHz	>25 KHz	>25 KHz	>25 KHz	>25 KHz	>25 KHz
Isolation Tx-Tx, dB	> 60 dB	> 80 dB	> 60 dB	> 80 dB	> 60 dB	> 80 dB
Insertion losses@Tx-Tx spacing	4.0 @50 KHz	4.5 @50 KHz	6.0 @50 KHz	6.5 @50 KHz	7,2 @50 KHz	7,7 @50 KHz
Nominal impedance	50	50	50	50	50	50
Connector	N - female	N - female	N - female	N - female	N - female	N - female
Dimensions (H x W x D) mm	400x420x210	400x420x210	400x630x210	400x630x210	400x420x420	400x420x420
Weight	5 Kg	5.7 Kg	7.2 Kg	8 Kg	13 Kg	14 Kg

FOR CHANNEL HYBRID COMBINER

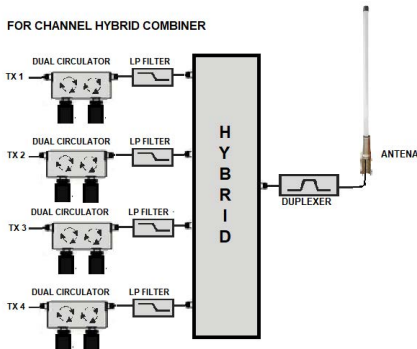

TWO CHANNEL HYBRID COMBINER

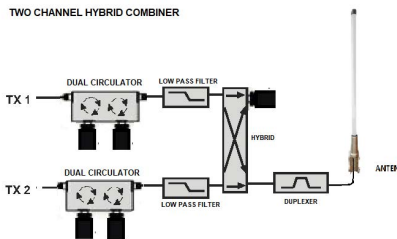

Mechanical Drawing

Single isolator

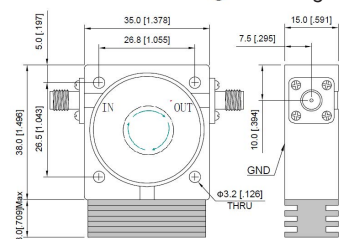

Mechanical Drawing

Dual isolator

